

Montgomery – Russell I-90 Bridge Overwidth Truck Restriction

Westbound Width Restrictions - Beginning the night of April 27, 2025

What is happening?

Beginning at 8:00PM on Sunday, April 27, 2025, MassDOT will be implementing a necessary lane split on I-90 Westbound over the Montgomery-Russell Bridge (Woronoco Bridge) on I-90 at approximately mile marker 36. The lane split and width restriction will be in place for approximately two months.

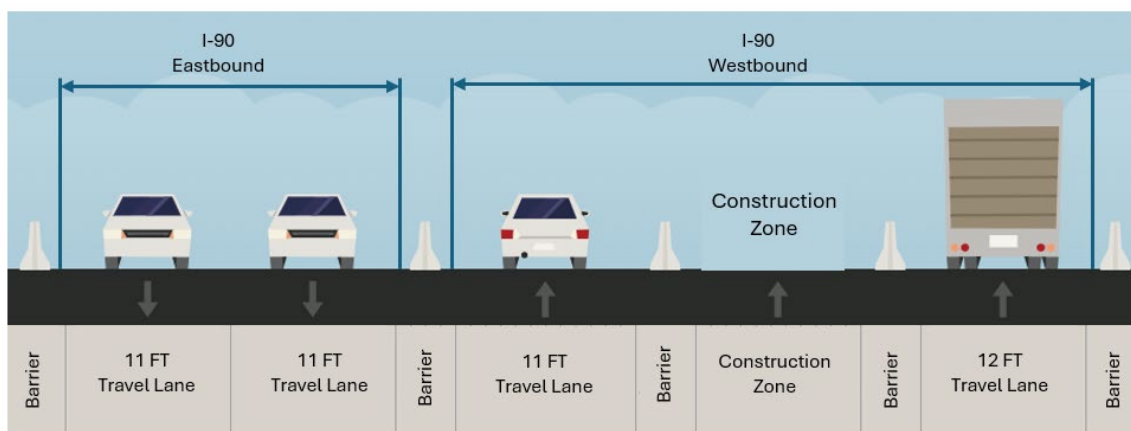

Due to this lane split, trucks over 11 feet wide will be required to utilize the current weight-restriction detour at Exit 41. All trucks under 11 feet remaining on I-90, and buses, must use the right travel lane.

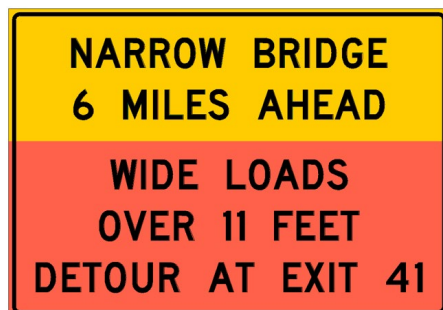

Sign to be posed approximately
1-mile prior to Exit 41



Sign to be posed prior to the bridge

Reminder

Loads over the posted limits will still be required to detour off I-90 and onto Routes 10, 202, and 20. Overweight trucks will not be permitted to utilize the detour route during peak hours of 7-9 AM and 4-6 PM.

Advance truck detour signs have been posted on I-90 and detour signs have been posted along the detour route.